

WILDCAT

BY FOREST RIVER



Keep Exploring



Scan for more info!

WILDCAT FIFTH WHEELS

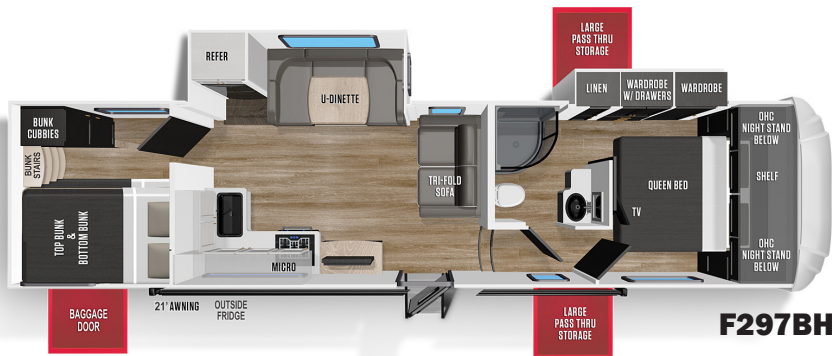

Length: 35' 6" • Height: 13' 3" • Hitch: 2,035 lb. • UVW: 9,863 lb. • CCC: 3,201 lb.

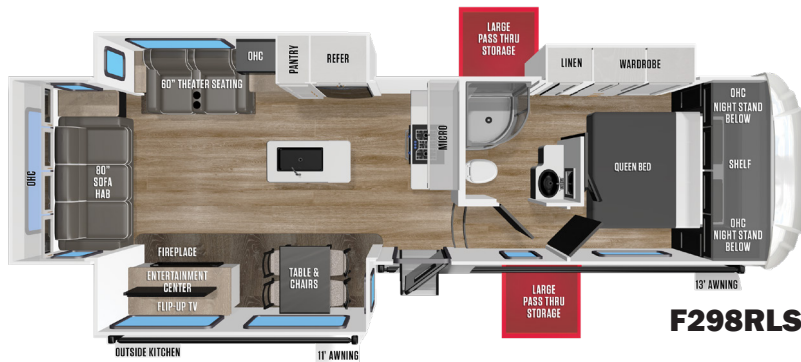

Length: 34' 9" • Height: 13' 3" • Hitch: 2,035 lb. • UVW: 10,834 lb. • CCC: 3,201 lb.

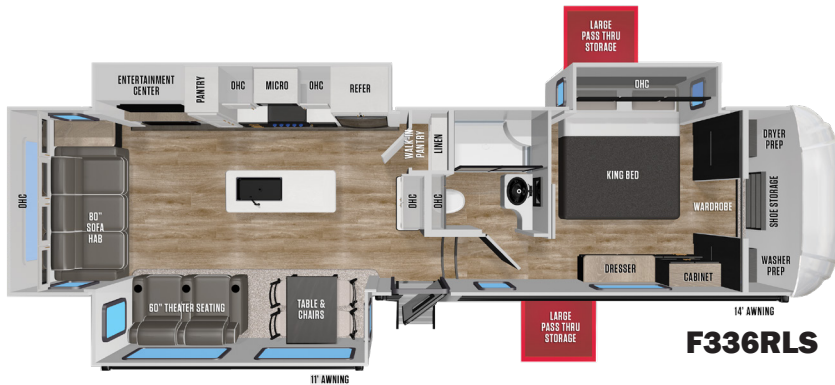

Length: 36' • Height: 13' 3" • Hitch: 1,940 lb. • UVW: 10,459 lb. • CCC: 3,481 lb.

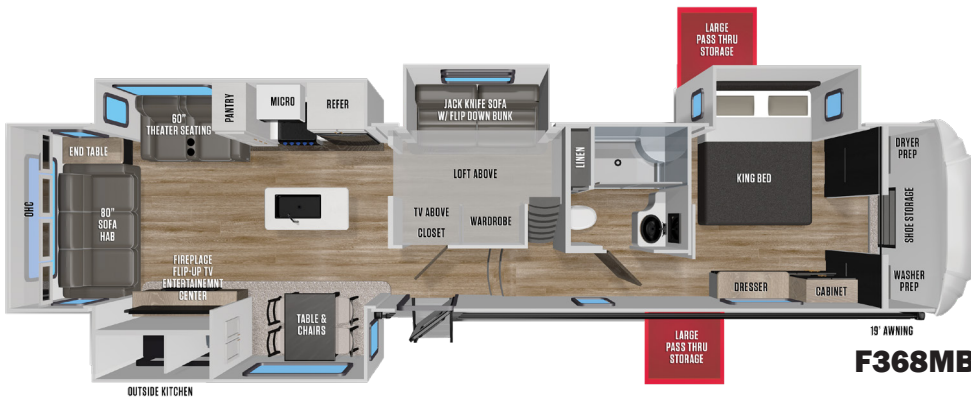

Length: 42' • Height: 13' 3" • Hitch: 2,315 lb. • UVW: 12,665 lb. • CCC: 1,650 lb.



WILDCAT TRAVEL TRAILERS

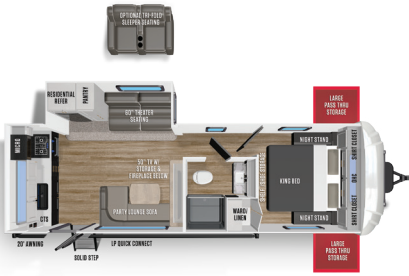

T247RKX

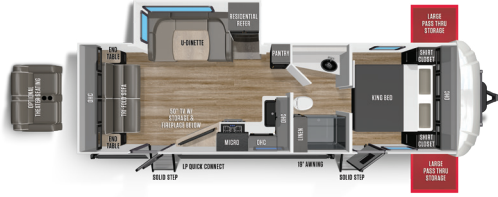

T262RSX

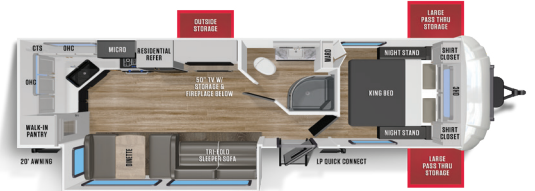

T266MEX

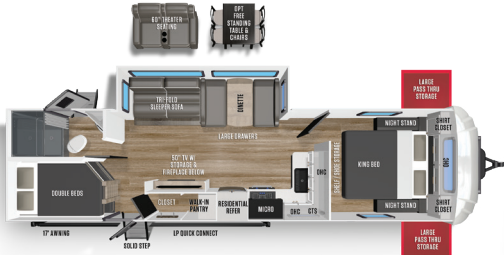

T269DBX

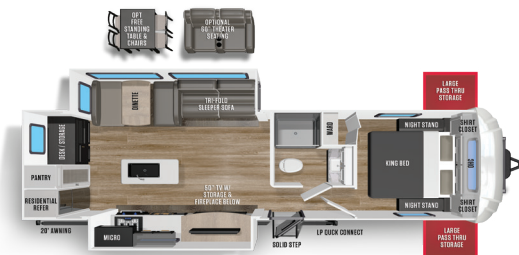

T272MKX

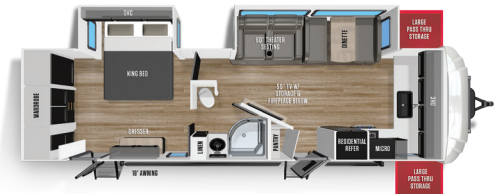

T276FKX

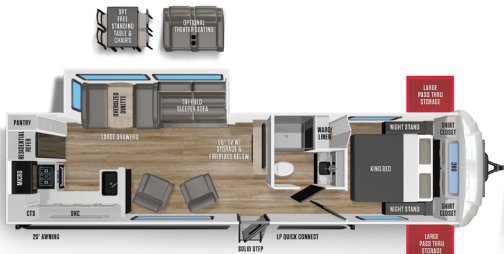

T282RKX

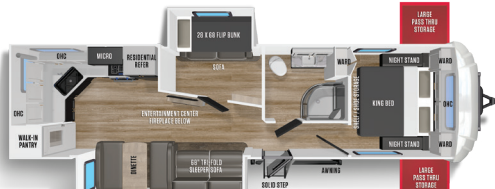

T303MBX

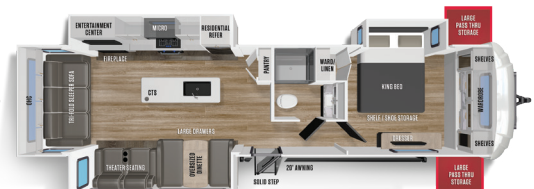

T323TSX



	T247RKX	T262RSX	T266MEX	T269DBX	T272MKX	T276FKX	T282RKX	T303MBX	T323TSX
LENGTH	30' 11"	31' 8"	32' 7"	34' 6"	33' 1"	33' 11"	34' 7"	35' 6"	37' 3"
HEIGHT	11' 5"	11' 5"	11' 5"	11' 5"	11' 5"	11' 5"	11' 5"	11' 5"	11' 5"
HITCH WEIGHT	680 LB.	693 LB.	912 LB.	984 LB.	887 LB.	1,045 LB.	954 LB.	830 LB.	1,241 LB.
UVW	6,747 LB.	6,918 LB.	7,097 LB.	7,339 lb.	7,665 LB.	7,992 LB.	7,533 LB.	8,155 LB.	8,992 LB.
CCC	2,733 LB.	2,575 LB.	2,615 LB.	2,445 lb.	2,022 LB.	1,853 LB.	2,221 LB.	1,475 LB.	2,449 LB.
FRESH WATER	61 GAL.	61 GAL.	61 GAL.	61 GAL.	61 GAL.	61 GAL.	61 GAL.	61 GAL.	61 GAL.
GREY WATER	64 GAL.	74 GAL.	74 GAL.	75 GAL.	74 GAL.	64 GAL.	64 GAL.	64 GAL.	108 GAL.
BLACK WATER	32 GAL.	32 GAL.	32 GAL.	33 GAL.	32 GAL.	32 GAL.	32 GAL.	32 GAL.	54 GAL.
AWNING	19'	19'	20'	17'	20'	18'	20'	20'	13'



F368MB



F336RLS

WILDCAT *Keep Exploring*

BY FOREST RIVER



PRE-DELIVERY INSPECTION FACILITY
20,000 square feet of quality assurance. The bare essentials for a premium product. This state-of-the-art facility gives immediate daily feedback to production for quality assurance in every unit built.



www.ForestRiverBuyLocal.com

Download our Forest River mobile app or visit our dynamic online manual to enhance your ownership experience. These interactive options provide incredible ease and insight into use, maintenance and enjoyment of your Forest River product.

Ranging from "How-To" videos, pictures and illustrations of various components, systems and features, to fully searchable content and downloadable PDFs for individual component owner's manuals, answers are always just a click away. View the online manual at www.forestriverinc.com/OnlineManual or download our FREE app from the App Store or Google Play!



GVWR (Gross Vehicle Weight Rating) - is the maximum permissible weight of the unit when fully loaded. It includes all weights, inclusive of all fluids, cargo, optional equipment and accessories. For safety and product performance do NOT exceed the GVWR.

GAWR (Gross Axle Weight Rating) - is the maximum permissible weight, including cargo, fluids, optional equipment and accessories that can be safely supported by a combination of all axles.

UVW (Unloaded Vehicle Weight)* - is the typical weight of the unit as manufactured at the factory. It includes all weight at the unit's axle(s) and tongue or pin and LP Gas. The UVW does not include cargo, fresh potable water, additional optional equipment or dealer installed accessories.

CCC (Cargo Carrying Capacity)** - is the amount of weight available for fresh potable water, cargo, additional optional equipment and accessories. CCC is equal to GVWR minus UVW. Available CCC should accommodate fresh potable water (8.3 lbs per gallon). Before filling the fresh water tank, empty black and gray tanks for more cargo capacity.

*Estimated Average based on standard build optional equipment. ** Estimated average based on standard build optional equipment. Values estimated at time of printing.

Each Forest River RV is weighed at the manufacturing facility prior to shipping. A label identifying the unloaded vehicle weight of the actual unit and the cargo carrying capacity is applied to every Forest River RV prior to leaving our facilities. The load capacity of your unit is designated by weight, not by volume, so you cannot necessarily use all available space when loading your unit.

All information contained in this brochure is believed to be accurate at the time of publication. However, during the model year, it may be necessary to make revisions and Forest River, Inc., reserves the right to make all such changes without notice, including prices, colors, materials, equipment and specifications as well as the addition of new models and the discontinuance of models shown in this brochure. Therefore, please consult with your Forest River, Inc., dealer and confirm the existence of any materials, design or specifications that are material to your purchase decision. ©2021 Wildcat, a division of Forest River Inc., a Berkshire Hathaway company.

FREE MEMBERSHIP
to Forest River Owners' Group



www.forestriverfrog.com

**24/7 EMERGENCY
ROADSIDE ASSISTANCE
WITH VEHICLE PURCHASE***

TOWING	WINCH-OUT
JUMP-STARTS	MOBILE MECHANIC
TIRE CHANGES	TECHNICAL
FLUID DELIVERY	SUPPORT
LOCKOUT SERVICE	DEALER LOCATOR SERVICES



*VALID FOR 1 YEAR FROM DATE OF PURCHASE



Learn More
Scan this barcode using a QR Reader on your smart phone to learn more about Forest River.



A Berkshire Hathaway company.